

# Global Shoreline 26.2m Monohull

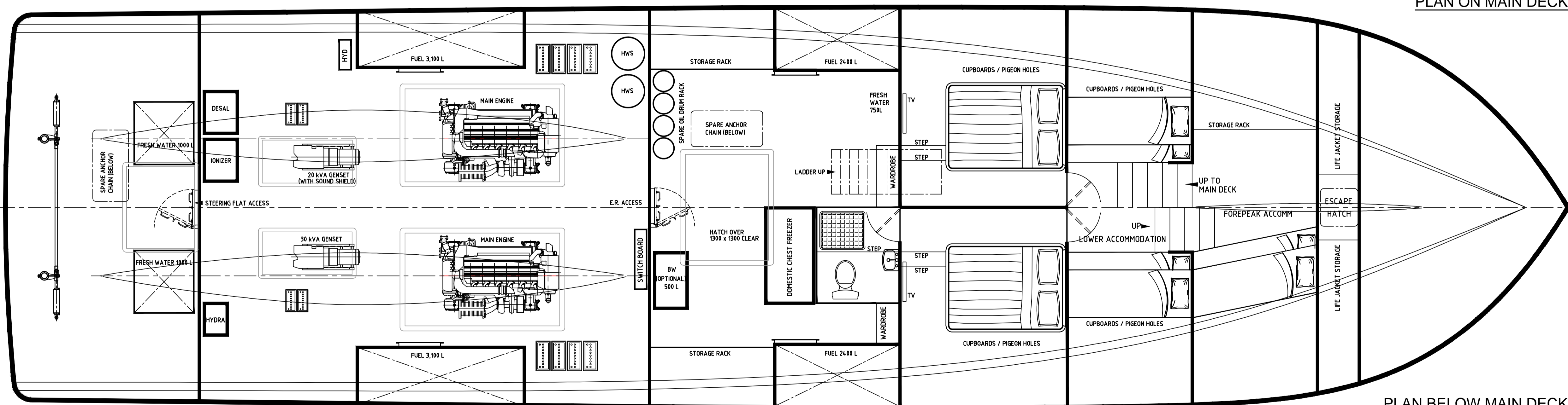

VESSEL PARTICULARS	
LENGTH OVERALL:	26.200 m
LENGTH HULL:	26.200 m
LENGTH WATERLINE:	25.160 m
MOULDED BEAM:	6.720 m
REFERENCE DRAFT:	1.915 m
DISPL. @ REF. DRAFT:	57.850 TONNES
FRESH WATER:	2,250 LITRES
FUEL CAPACITY:	10,000 LITRES APPROX.
ENGINES:	2 x YANMAR 6AYEM-GT 1000 HP @ 2000 RPM
GEARBOXES:	TWIN DISC MGX 6599A 2.48 : 1
HEIGHT TO TOP OF RAIL:	1000mm ABOVE DECK
NSCV CLASS	3B

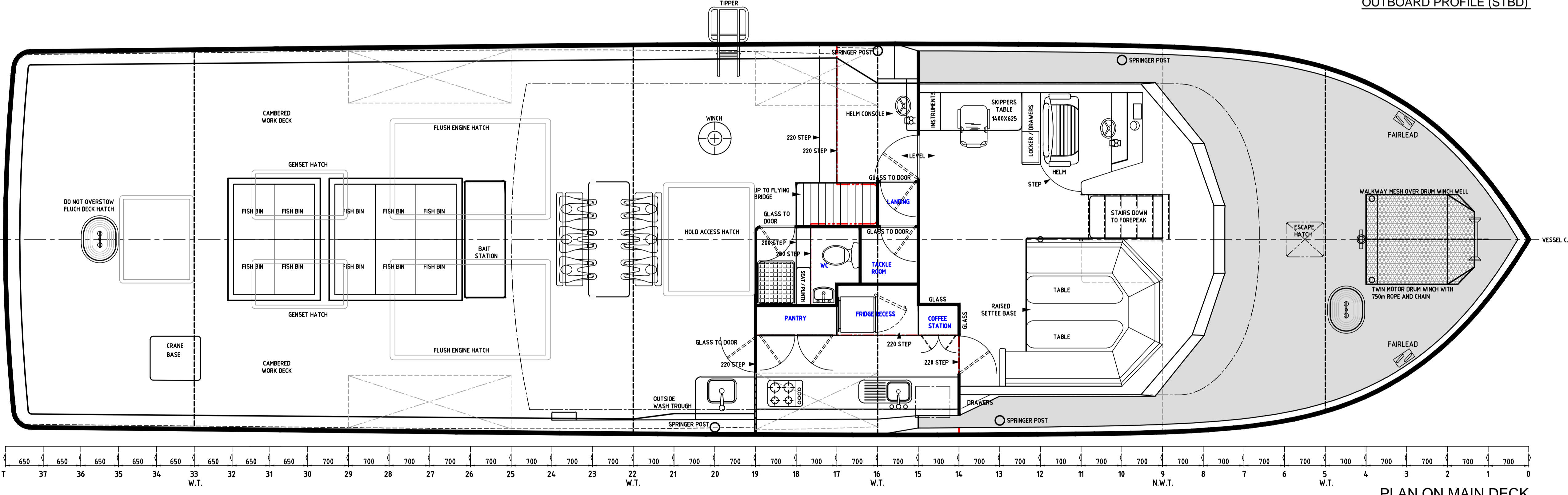
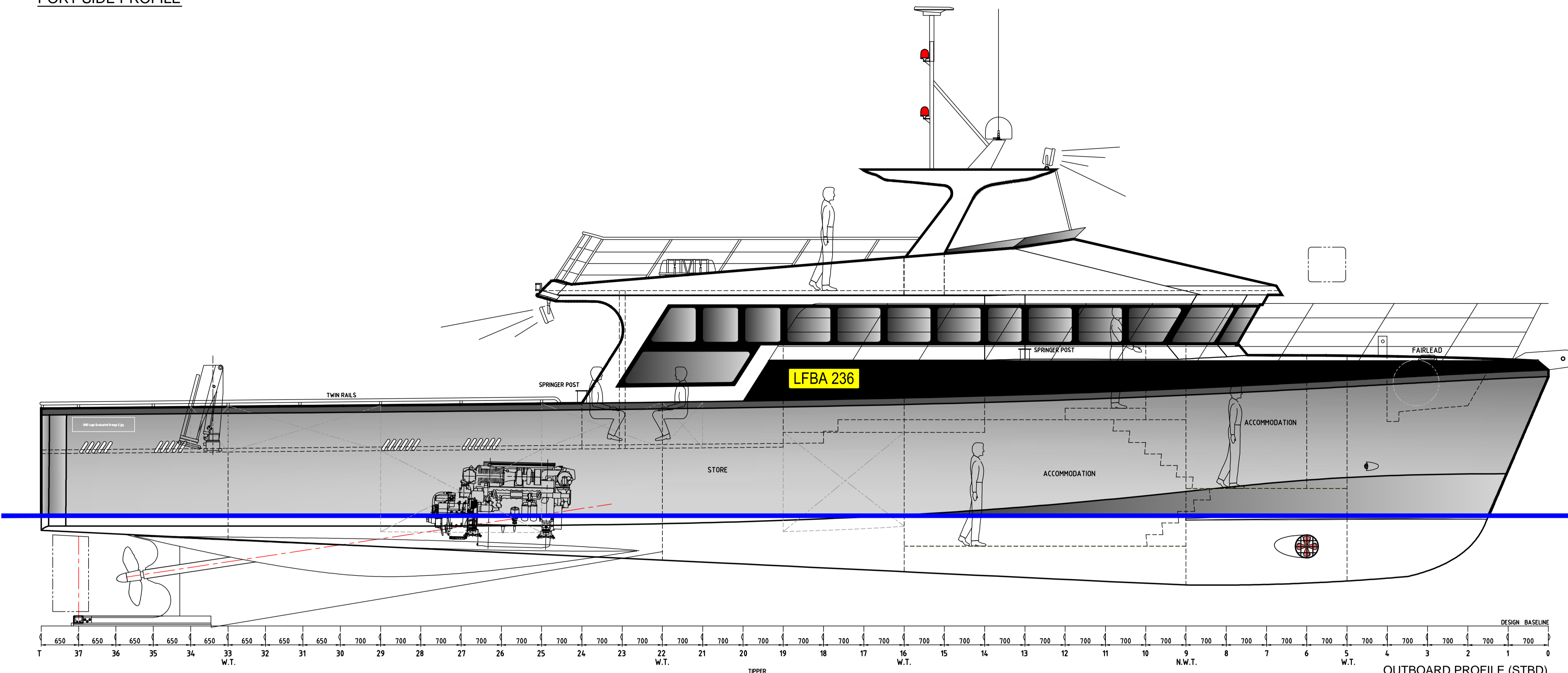
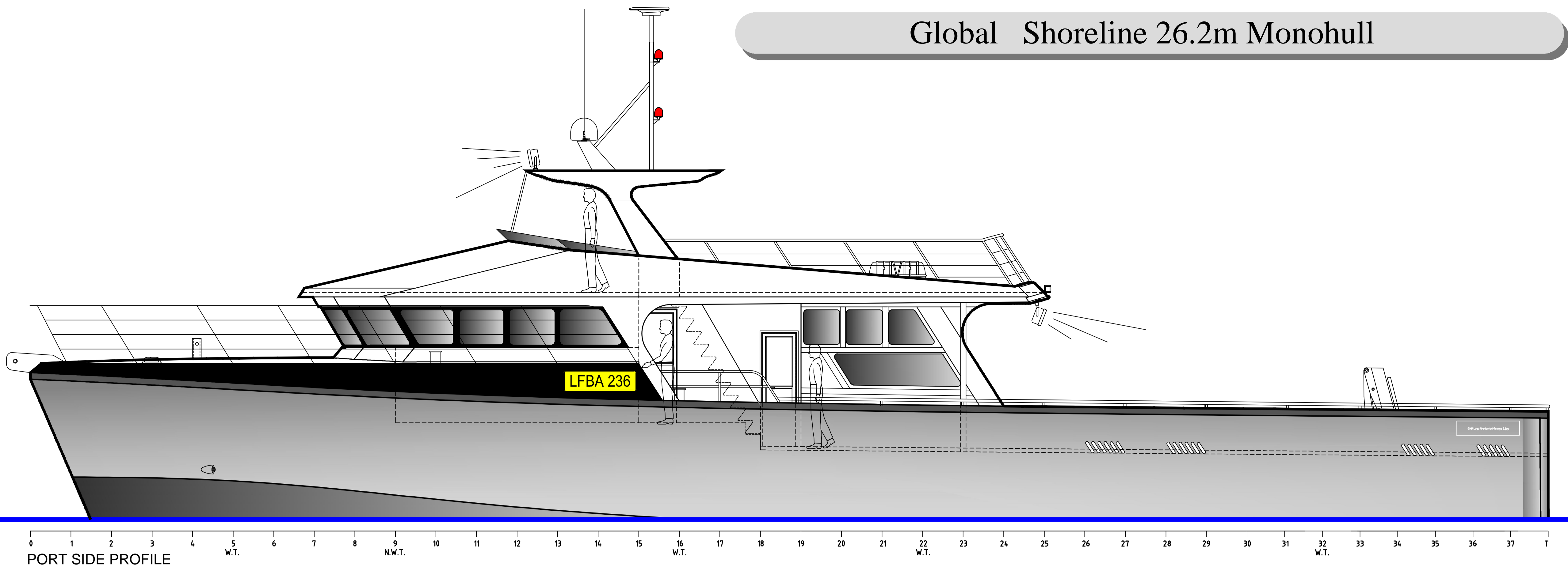
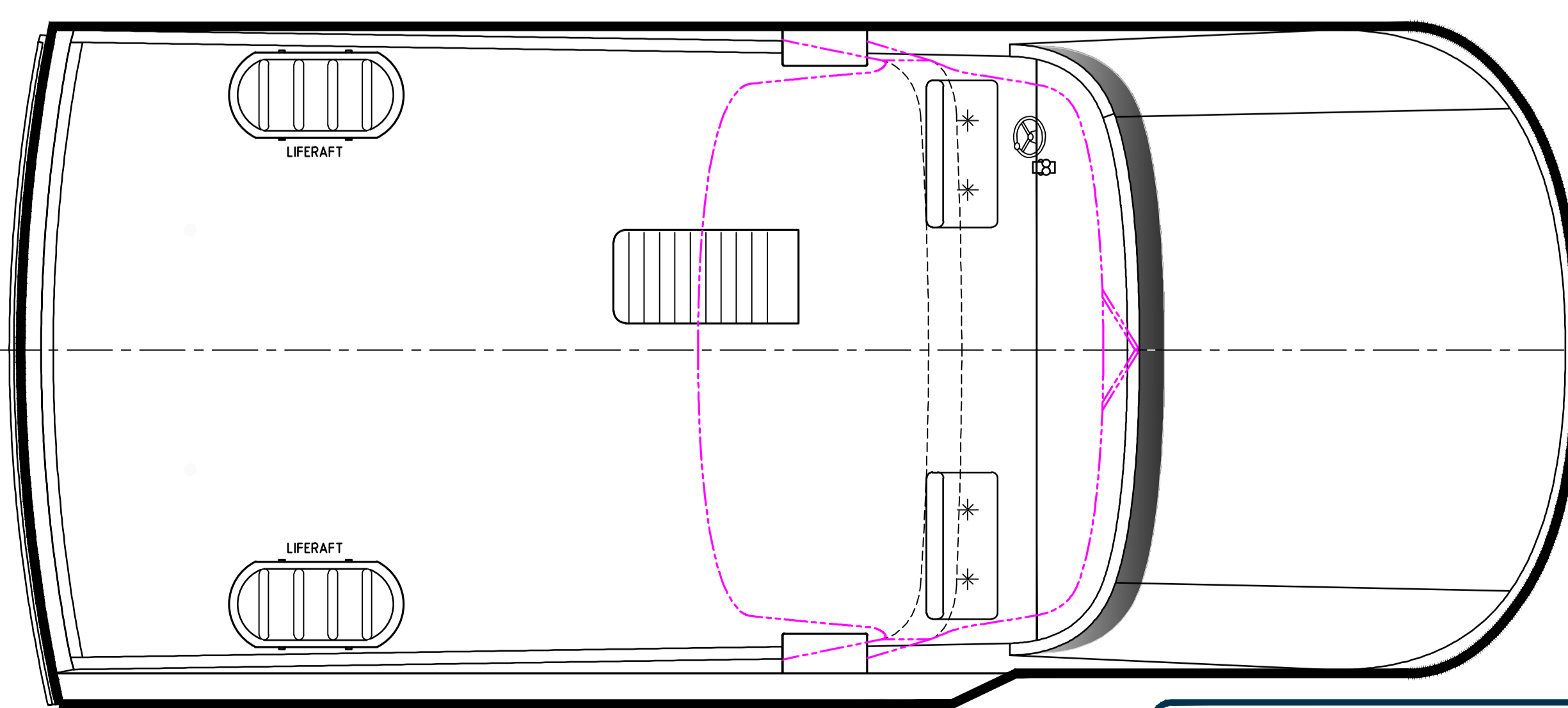

APPROVED BY OWNER

0 1 2 3 4 5 6 7 8 9 10 METRES

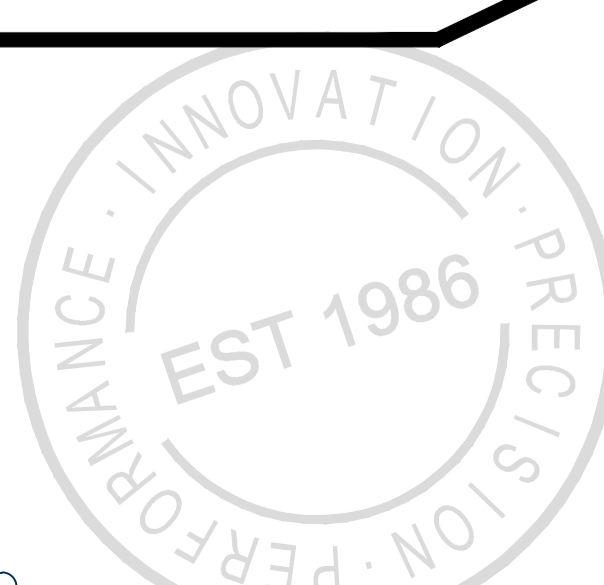

		Global Marine Design Pty Ltd 5 / 43 Burlington Street Naval Base, Western Australia 6165 T+61 (0)8 9437 1319 F+61 (0)8 9437 2030 globalmadesign.com ABN:11 101 353 851	
DRN: GMD	CLIENT: -	TITLE: GENERAL ARRANGEMENT PLAN	
APPD: 25.01.18	VESSEL: 86' MONOHULL	REV: A1	
BUILDER: Shoreline M.F.		SCALE: 1:60	
DESIGN No: 17051		SHEET 1 OF 1	